

Knowledge Article: Installing the Konica MFP via the PaperCut Print Deploy Client for macOS

Introduction

This article provides a concise guide to installing the Konica MFP printer via the PaperCut Print Deploy Client on macOS. Ensure you have administrator privileges and a working internet connection.

What You Need

- A macOS computer
- PaperCut Print Deploy Client (downloadable via UHasselt)
- Konica MFP printer driver (if needed)
- Your Staff or Student ID and password

Step-by-Step Guide

1. Log in to PaperCut

- Go to `webprint.uhasselt.be`, enter your ID and password, and click "Log in" (Screenshot 1).

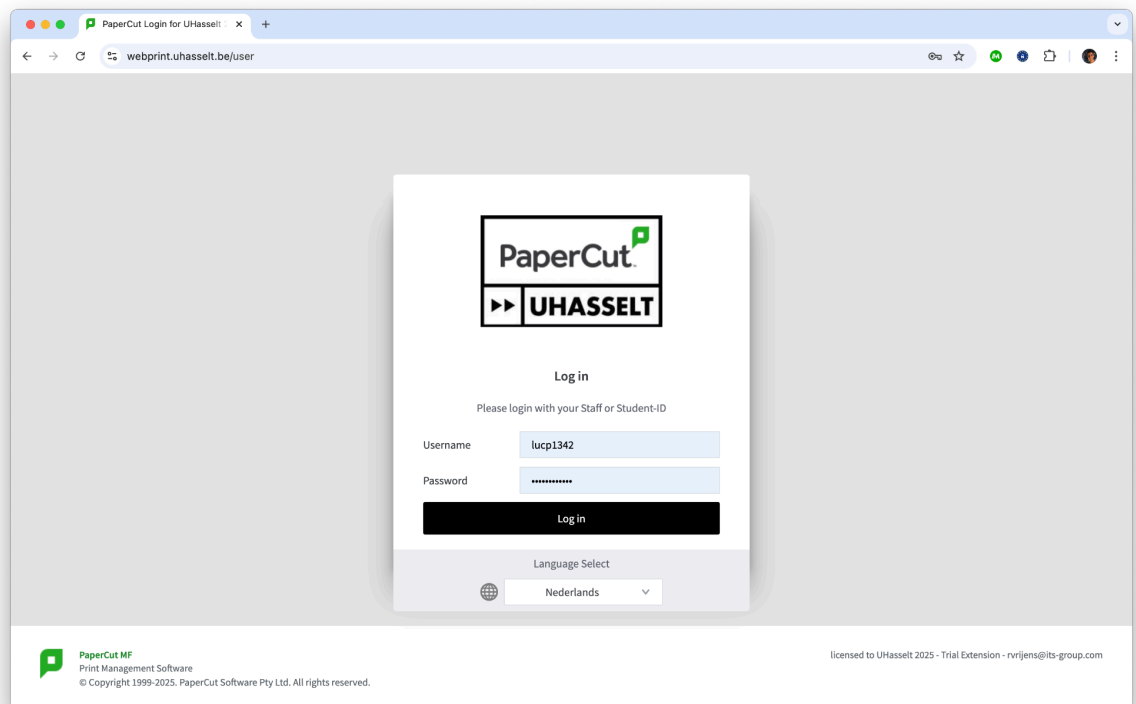

- View your overview with balance and printing activity (Screenshot 2).

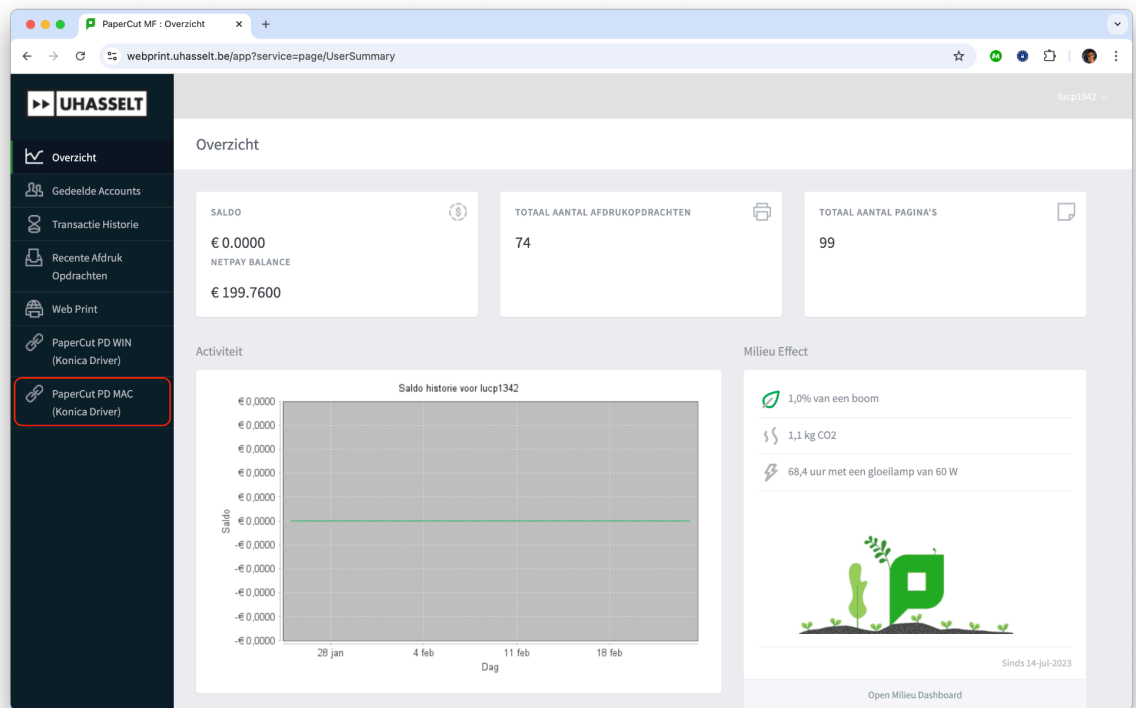

2. Download the Client

- Download `pc-print-deploy-client[papercut.uhasselt.be].dmg` from the website (Screenshot 3).

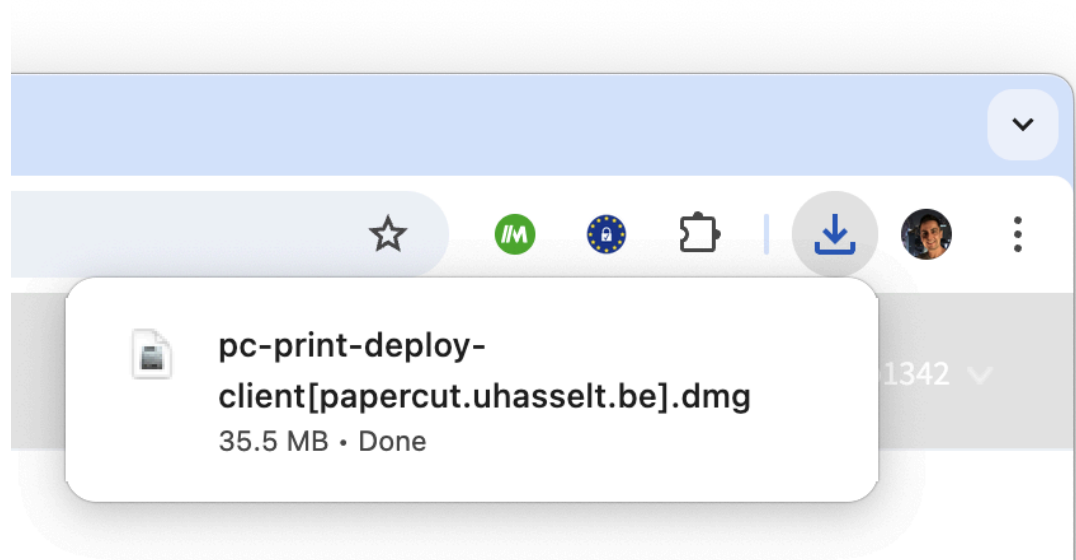

- Open the file in the Downloads folder (Screenshot 4).

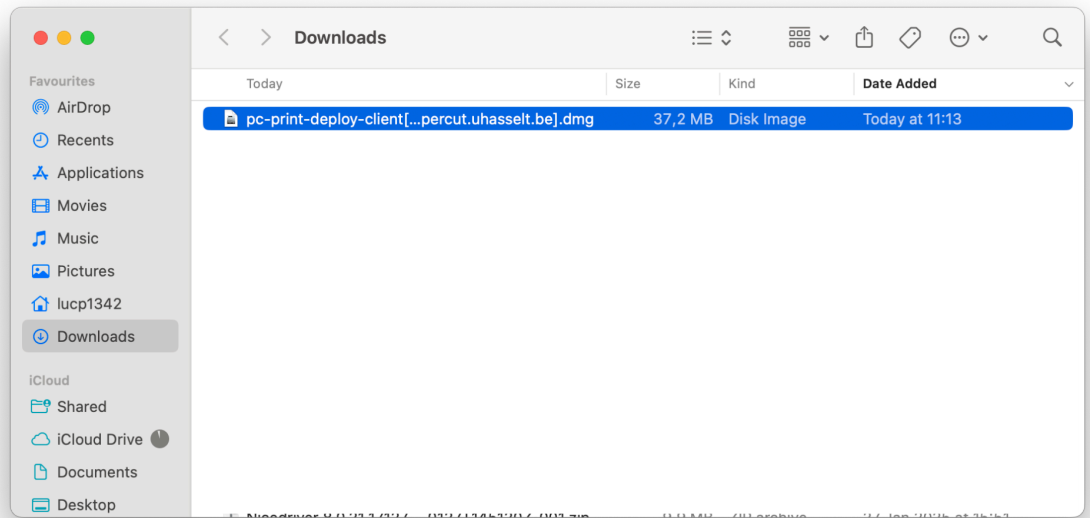

3. Start the Installation

- Double-click the .dmg file to open PaperCut Print Deploy Client.pkg (Screenshot 5).

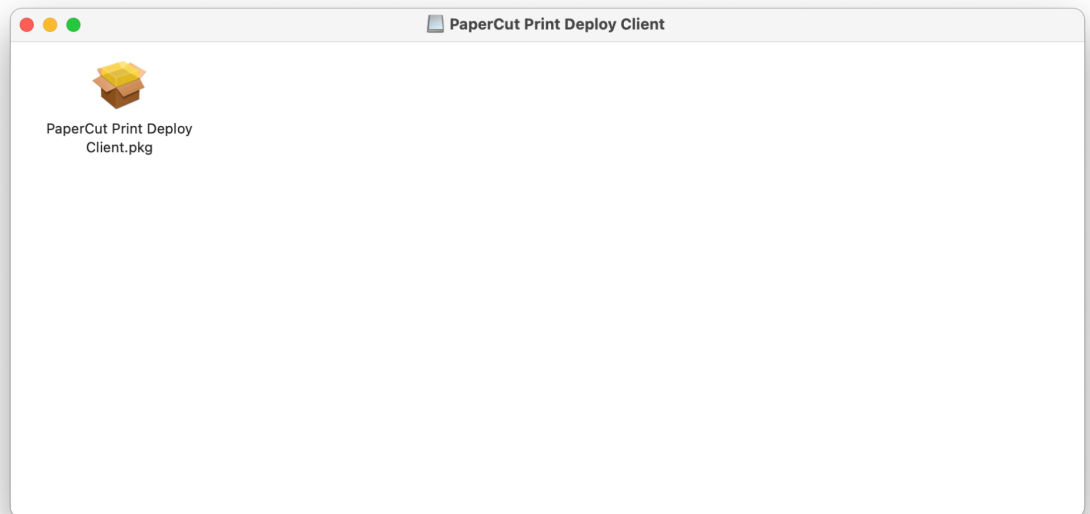

- Follow the installation wizard: click "Continue" on the welcome screen (Screenshot 6).

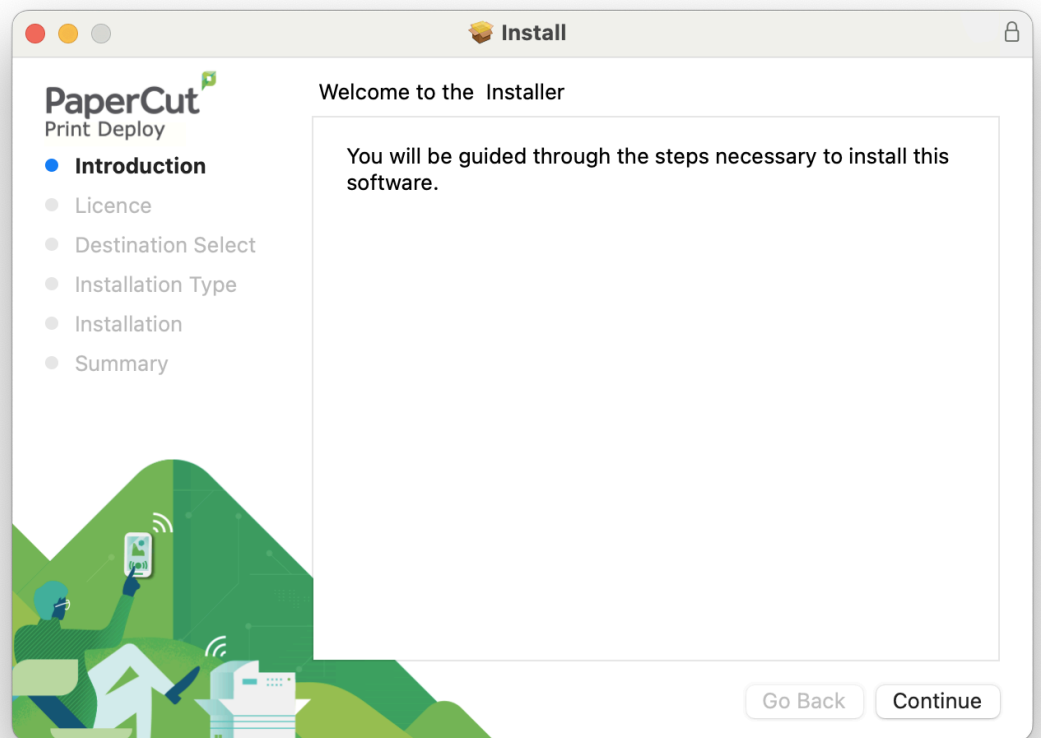

4. **Accept the License**

- Read and accept the "Software Licence Agreement" by clicking "Continue" (Screenshot 7),

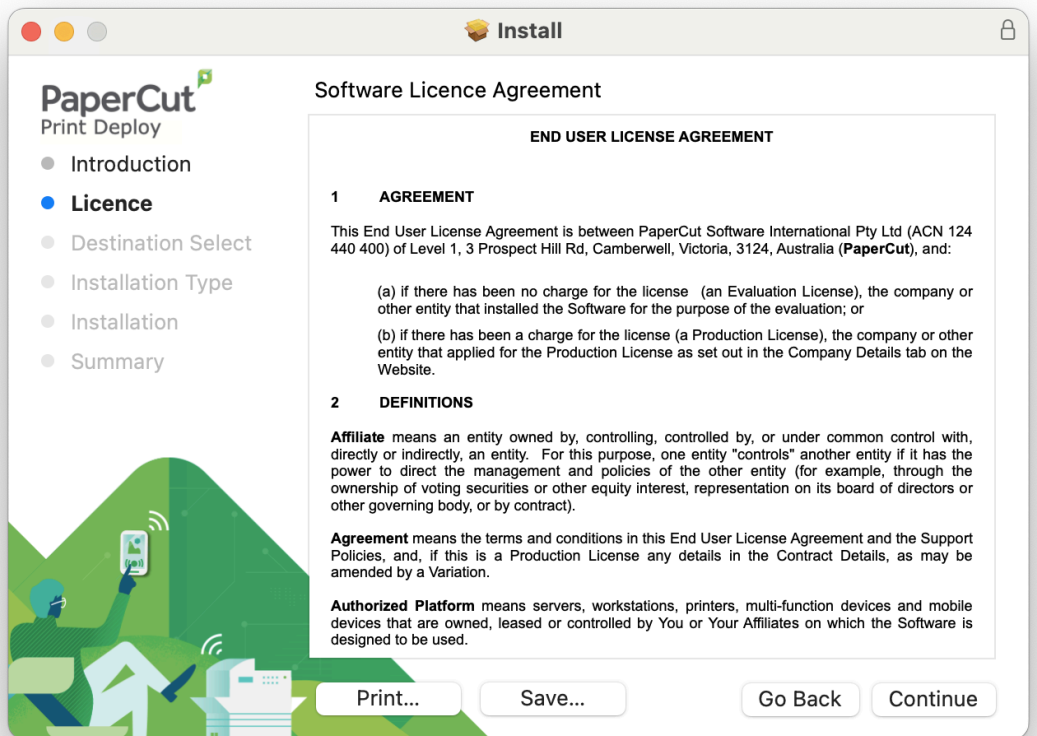

and confirm with "Agree" (Screenshot 8).

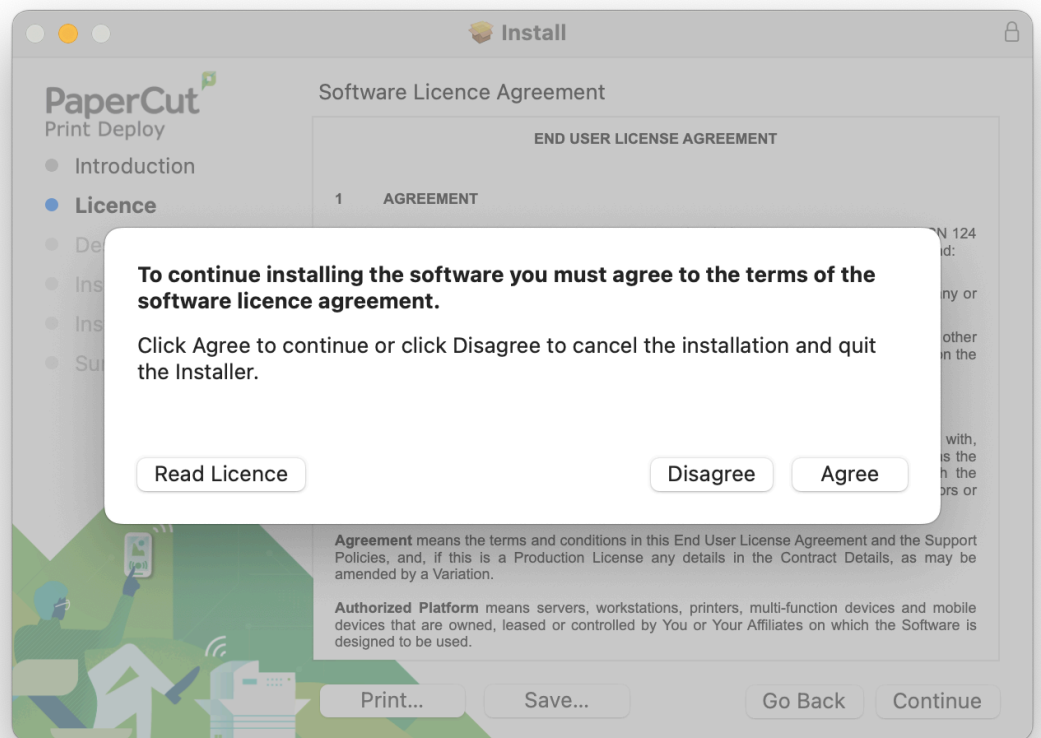

5. Select Installation Location and Install

- Choose a standard installation on "Macintosh HD" (80.1 MB of space) and click "Install" (Screenshot 9).

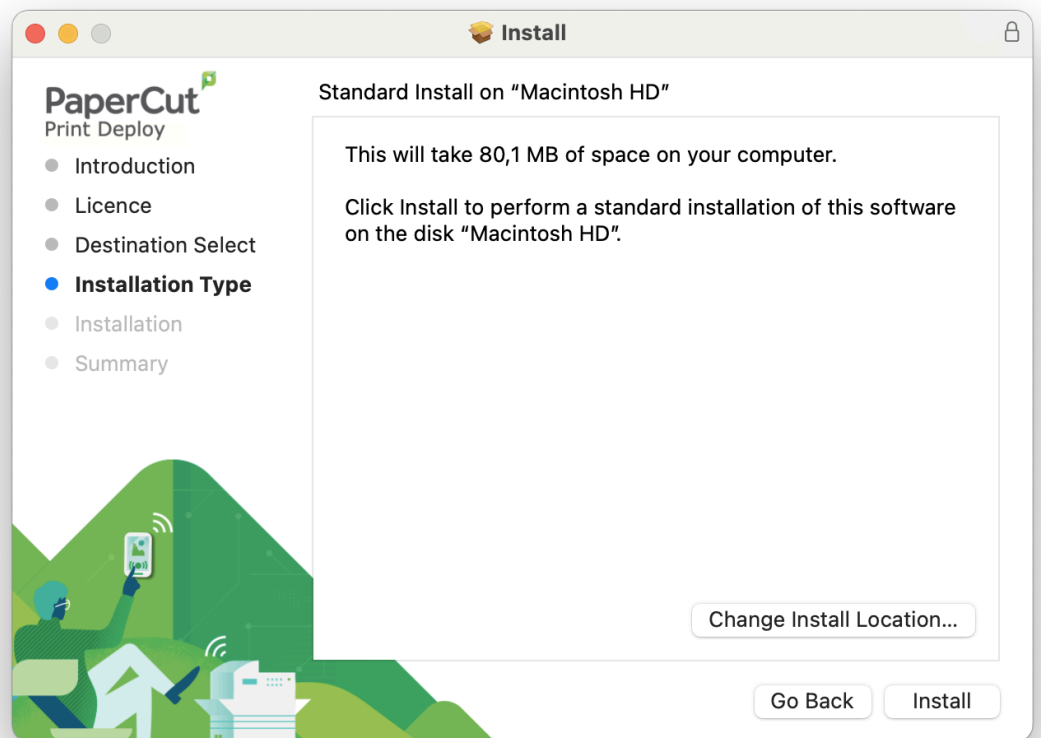

- Grant administrator privileges via "Use Password..." or Touch ID (Screenshot 10).



- Wait for the installation to complete ("Running package scripts...") (Screenshot 11).

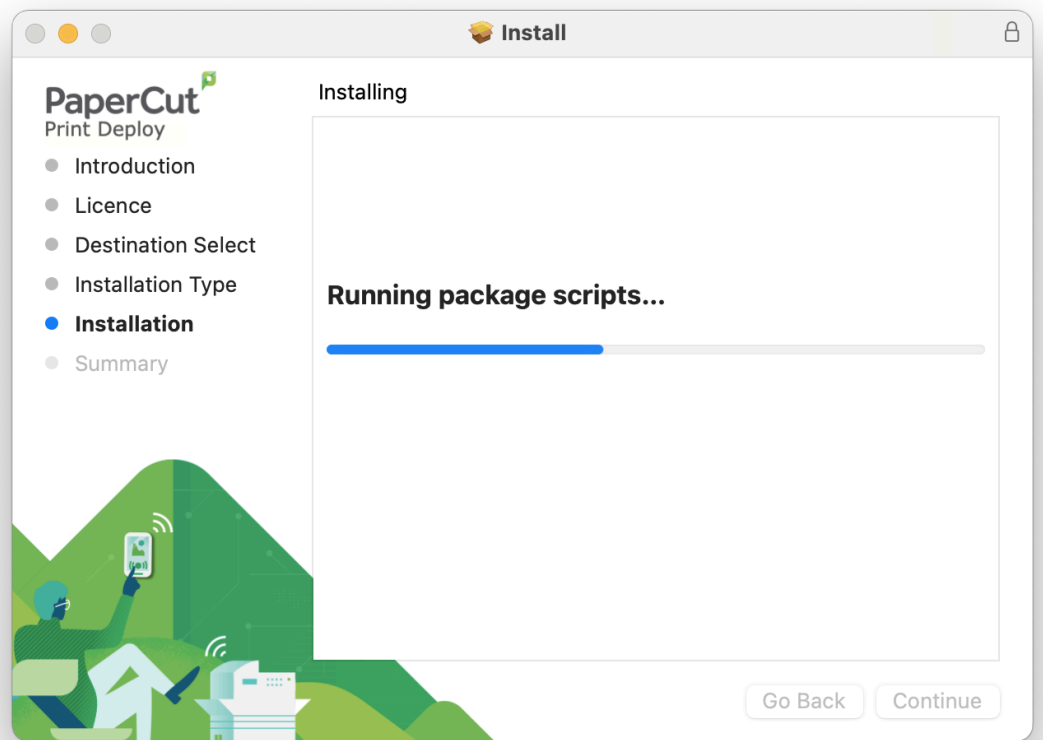

- Confirm system administration rights with "Allow" (Screenshot 12).

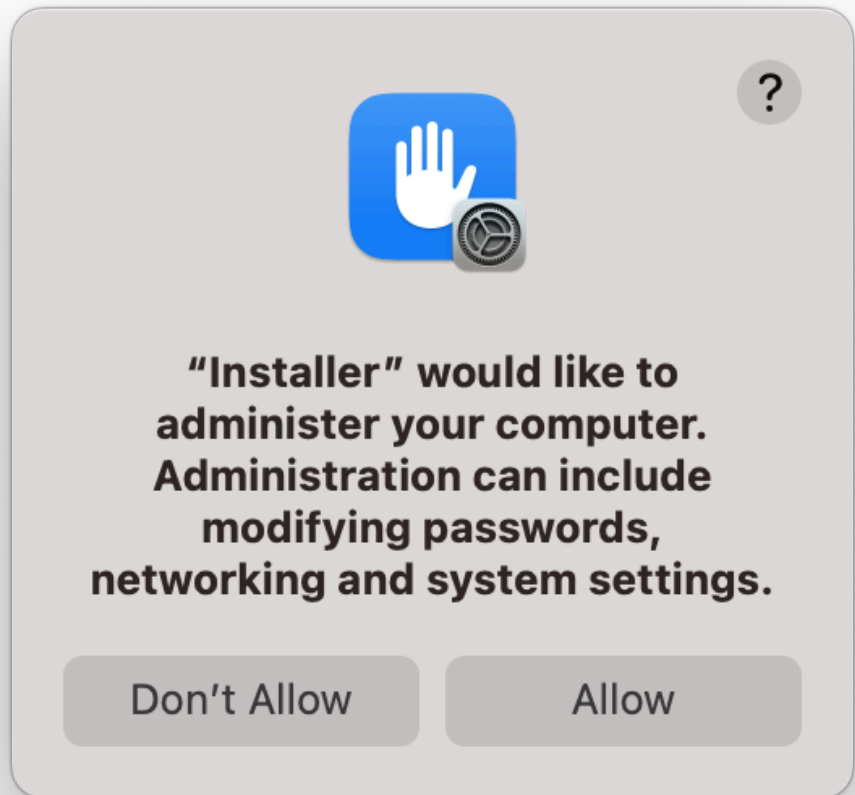

6. Sign In to PaperCut Print Deploy Client

- After the installation, open the PaperCut Print Deploy Client application. You'll see a sign-in screen prompting you to log in so the correct printers are added to your device.
- Enter your username (e.g., `lucp1342`) and password in the respective fields, then check "Don't show me this again" if you want to skip this step in the future.

- Click "Sign in and add printers" to proceed (Screenshot 13).

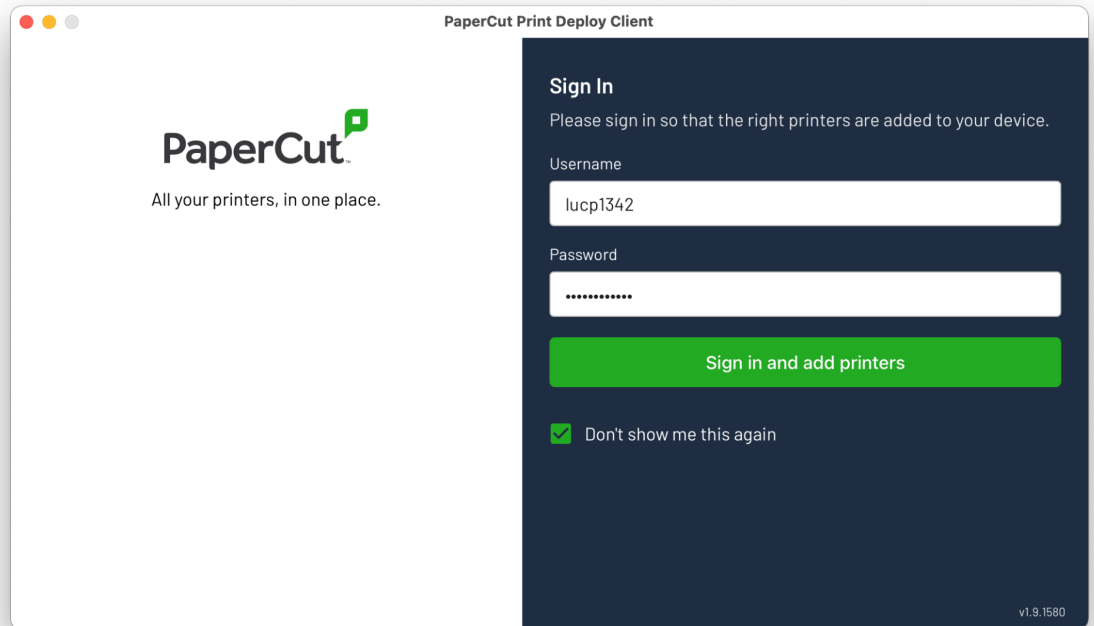

- Once signed in, you'll see a confirmation that the printer (e.g., "KonicaLPR") was installed, listed under "My printers" (Screenshot 14).

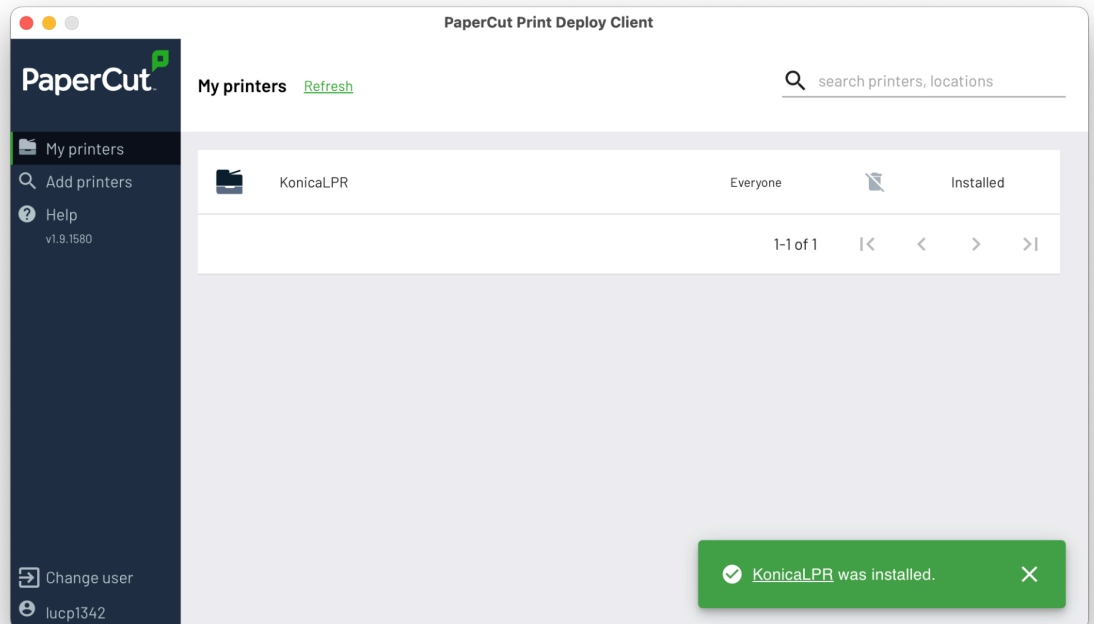

7. Complete and Verify

- Close the wizard after the success message ("The installation was successful") with "Close" (Screenshot 15).

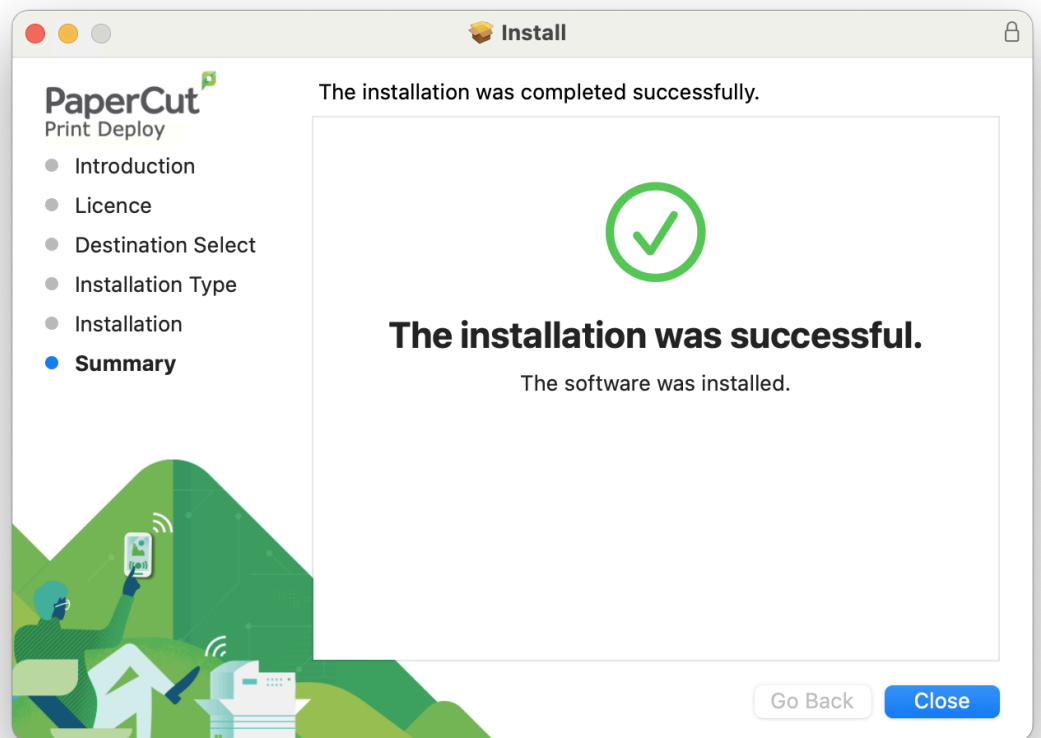

- Optionally remove the installation file with "Move to Bin" (Screenshot 16).

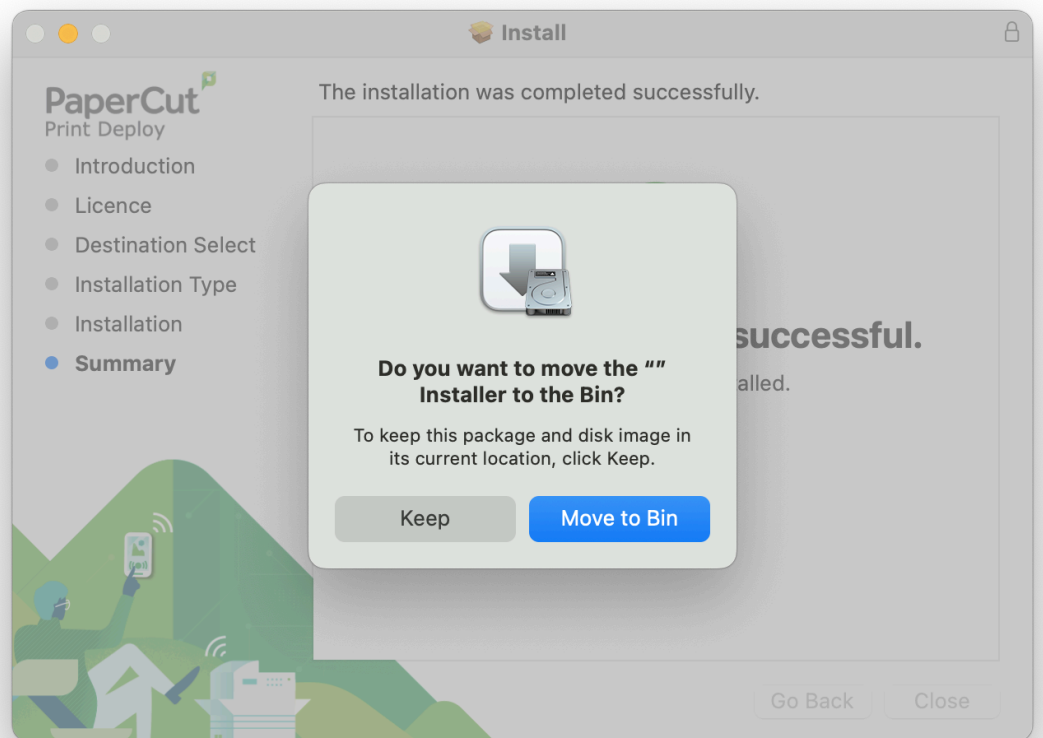

- Verify the printer ("KonicaLPR") in "Printers & Scanners" in System Settings (Screenshot 17).

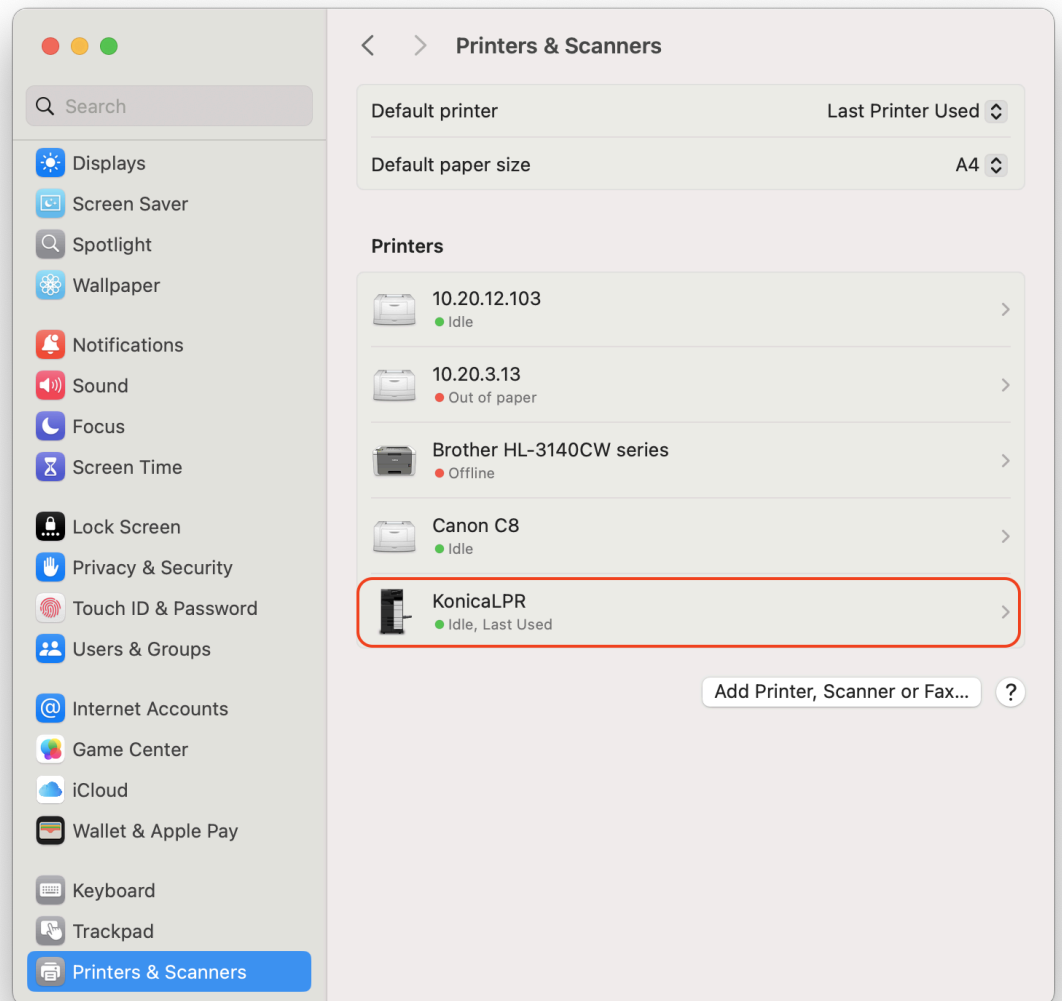

Conclusion

The PaperCut Print Deploy Client and Konica MFP printer are now installed and ready for use. For any issues, consult the ICT service desk.