

How to Copy?

1. Log on to a device of your choosing:

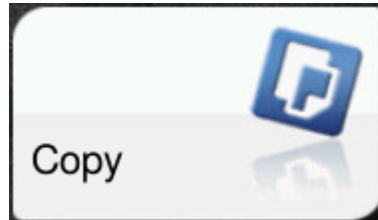

3. Select:



Put your originals on the glass plate or document feeder on top of the device

5. Choose the correct finisher options



and press "Start"



2. You will land on the main menu:

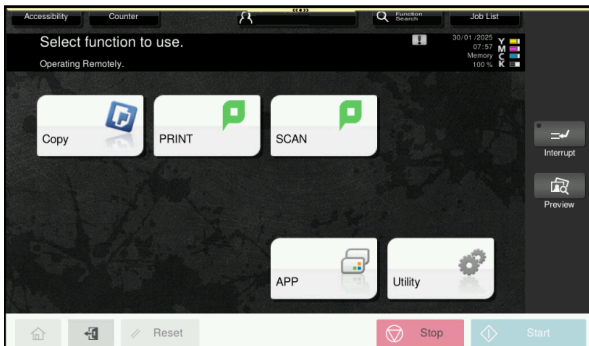

4. You will be redirected to the Copy menu

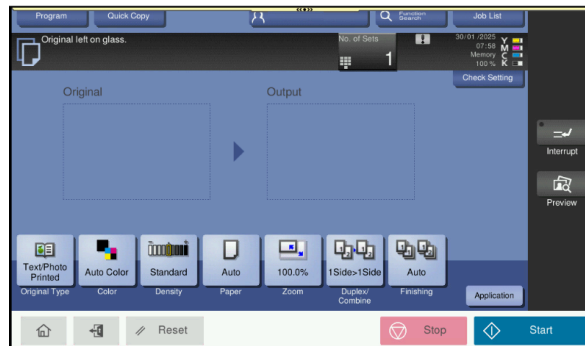

6. Logoff:

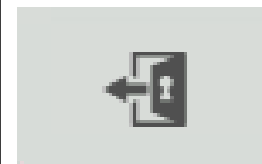

Press the button above to logoff

How to Print?

1. Log on to a device of your choosing:



3. Select:

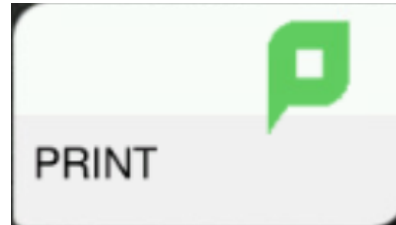

Press "Print".



Your Print jobs will be printed

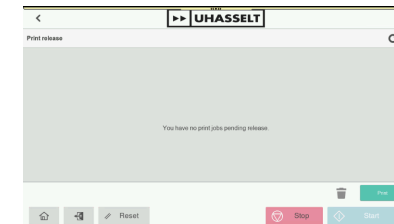

2. You will land on the main menu:

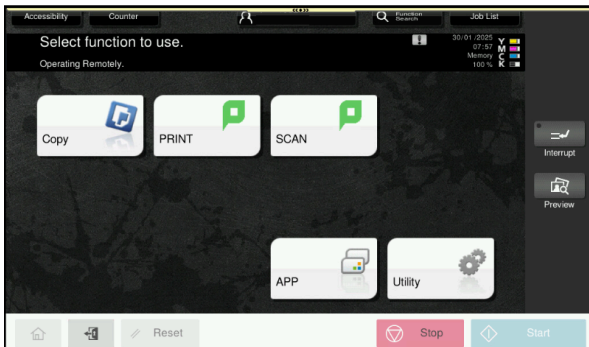

4. You will be redirected to the Print menu; select the documents to be printed from the list

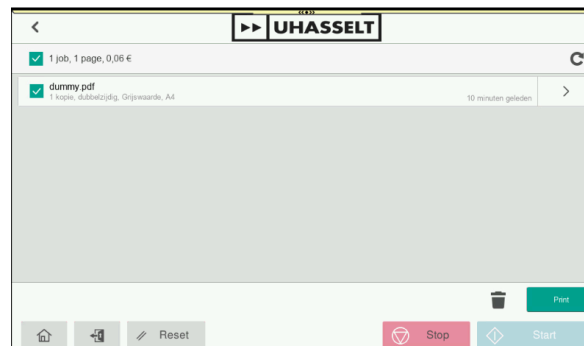

6. Logoff:

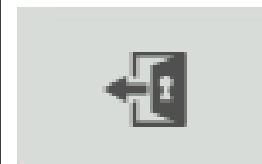

Press the button above to logoff

How to Scan?

1. Log on to a device of your choosing:



3. Select:

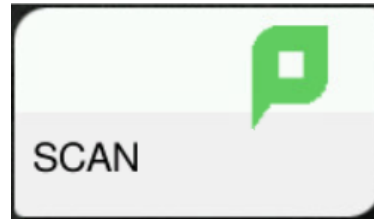

Put your originals on the glass plate or document feeder on top of the device

Press "Start" in the screen below

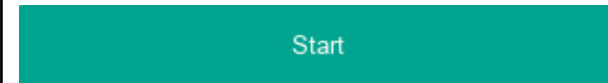
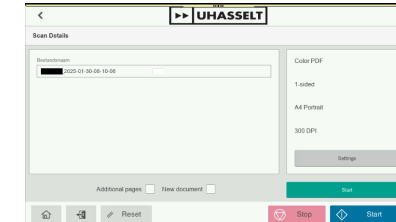

You will receive an email with further instructions

2. You will land on the main menu:

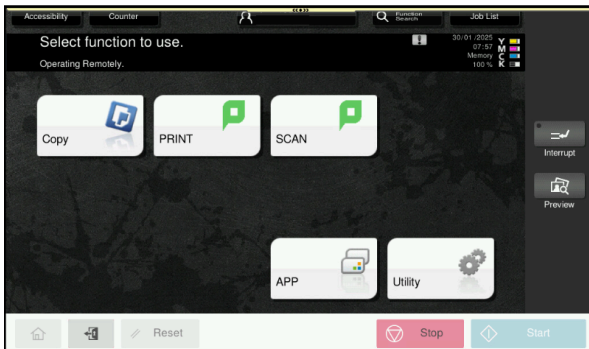

4. You will be redirected to the Print menu; select "Scan" or "OMR"

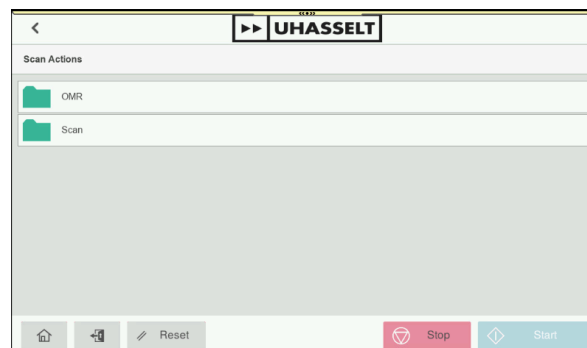

6. Logoff:

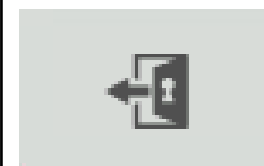

Press the button above to logoff